

RK100-06 shell is made of flame retardant and corrosion-resistant material. Based on the principle of pitot tube pressure measurement, the gas required for measurement is very little. The performance of RK100-06 shell is equally reliable even in harsh environment with a small amount of dust. The product can obtain higher reliability and repeatability by using digital linear compensation and temperature compensation.

## FEATURES

- High accuracy
- High resistance to the instantaneous wind speed
- Strong corrosion resistant ability
- Wide range, good stability
- Full pressure (dynamic pressure + static pressure) can be measured by orifice alignment with wind direction.
- Easy Installation



## APPLICATIONS

- HVAC
- Flue Gas Treatment in Power Plant
- Textile and Chemical Industry
- Pipeline Air Flow Monitoring
- VAV system
- Purifying Environmental Ventilation System

## SPECIFICATIONS

Item	Specification
Range	0-100Pa,0-250Pa,0-500Pa,0-1000Pa,0-2000Pa,0-5000Pa,0-10000Pa
Supply	24VDC
Output	4-20mA,0-10V,RS485
Response time	<1s
Accuracy	±1%FS
Resolution	1Pa
Power consumption	<40mA@24VDC(4-20mA) <20mA@24VDC(RS485,0-10V)
Display	LCD optional
Ingress Protection	IP65
Operating Temperature	-20°C-+70°C
Main material	Flame retardant ABS
Probe length	220mm typ., Other length(<1500mm) can be customized
Storage Condition	10°C-60°C@20%-90%RH

## OUTPUT

- 4-20mA

$$V(\text{Pa}) = ((I_{\text{out}} - 4) / (20 - 4)) * (\text{Range}_{\text{max}} - \text{Range}_{\text{min}}) + \text{Range}_{\text{min}}$$

- 0-10V

$$V(\text{Pa}) = (V_{\text{out}} / 10) * (\text{Range}_{\text{max}} - \text{Range}_{\text{min}}) + \text{Range}_{\text{min}}$$

- RS485

## DIMENSION & MOUNTING

When installing the product, please keep the direction of the arrow on the probe and the direction of the wind.

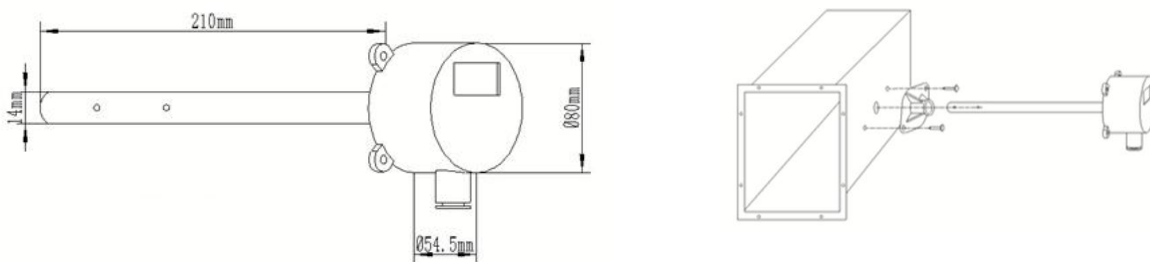

## PARAMETER SELECTION TABLE

Remark	Series	Type	Output	Range	Display	
RK						
	100					
		06				
			A		4-20mA	
			B		0-10V	
			C		RS485	
			X		Other	
				A	0-100Pa	
				B	0-250Pa	
				C	0-500Pa	
				D	0-1000Pa	
				E	0-2000Pa	
				F	0-5000Pa	
				G	0-10000Pa	
				X	Other	
					D	With display
					N	Without display

Example: RK100-06ABN Output:4-20mA,Range:0-250Pa, without display

The default power supply voltage is 24VDC,if you have other requirements please confirm when ordering.



Complies with applicable CE directives.

Specifications subject to change without notice. Version 3.0

Copyright © 2015 Hunan Rika Electronic Tech Co.,Ltd

---

**Hunan Rika Electronic Tech Co., Ltd**

Add: Building B5, Taskin, Yuhua District,  
Changsha City, Hunan Province,  
China



+86-731-85132979



info@rikasensor.com



www.rikasensor.com